

Notes:

Existing irrigation system shall be modified and repaired to ensure all existing and proposed plant material receives 100% irrigation coverage. (See general note19.) All new trees and any relocated trees shall have bubblers installed at base of tree.

All trees designated as single trunk shall have a single, relatively straight, dominant leader, proper structural branching and even branch distribution. Trees with bark inclusion, tipped branches and co dominant trunks will not be accepted. Trees with girdling intact leader circling and/ or plunging roots will be rejected.

No development, work, or demo activity shall be allowed within the dripline of a tree or tree protection area.

Penalties and fines may be incurred by the Contractor for any damage to the existing trees on site from the contractor or subcontractor. Any encroachment within the tree protection zone, failure to maintain the tree protection zone or any damage to the trees' critical root zones will result in mitigation fees.

All existing trees shall be pruned by an ISA Certified Arborist under the direction of a BCMA or ASCA Registered Consulting Arborist.

General Notes:

- All plant material shall be Florida No. 1 or better as given in the current Florida Grades and Standards for Nursery Plants, 2015, Florida Department of Agriculture and Consumer Services.
- All plant materials shall be subject to inspection and approval by the Landscape Architect at place of growth and upon delivery for conformity to specification.
- All plants shall be true to species and variety and shall conform to measurements specified. All substitutions shall be submitted to the City and Landscape Architect for final approval.
- All plants shall be exceptionally heavy, symmetrical, tight knit and so trained in appearance as to be superior to form, branching and symmetry.
- Contractor shall notify Sunshine 811 (call 811) for locations of existing utility lines 48 hours prior to beginning work. Contractor shall verify location of all utility lines and easements prior to commencing any work. Excavation in the vicinity of underground utilities shall be undertaken with care and by hand, if necessary. The Contractor bears full responsibility for this work and disruption or damage to utilities shall be repaired immediately at no expense to Owner.
- Grade B+ shredded sterilized Melaleuca or Eucalyptus mulch shall be used in all mass planting beds and for individual tree pits. All trees shall have a mulch ring with a depth of 3" and a diameter of 3'- 4' around their base. All mulch shall be kept 4" from base of all plant material. Mulch beds shall be a minimum of 12" wider than plants measured from outside edge of foliage. Mulch shall be maintained at a minimum thickness of 2 inches around shrubs and trees.
- Sod shall be St Augustine and free of weeds, insects, fungus and disease, laid with alternating and abutting joints.
- All road rock, concrete, asphalt and all other unnatural materials shall be removed from all landscape areas and replaced with approved planting soil prior to installation.
- All trees and shrubs shall be backfilled with a suitable planting soil consisting of 50 percent sand and 50 percent muck. All plant materials shall be planted with a minimum of 6 to 18 inches of planting soil around the root ball. Refer to planting details. Planting soil to be backfilled into plant pits by washing in. Planting beds shall be free from road, pea, egg or colored rock, building materials, debris, weeds, noxious pests and disease.
- All sodded areas to have a minimum of 2" of planting soil as described in note #9.
- All trees shall be warranted by the Contractor and will be healthy and in flourishing condition of active growth one year from date of final acceptance.
- All shrubs, groundcovers, vines and sod shall be fully warranted for 90 days under same condition as above.
- All synthetic burlap, synthetic string or cords or wire baskets shall be removed before any trees are planted. All synthetic tape shall be removed from trunks, branches, etc before inspection. The top 1/3 of any natural burlap shall be removed or tucked into the planting hole before trees are backfilled. Planting soil to be backfilled into pits by washing in.
- Only bio-degradable material can be attached to the trunks of trees.
- All trees and palms shall be planted with the top of their rootballs 1"-2" above finished grade. All other plants shall be planted with top of their rootballs no deeper than the final grade surrounding the planting area. If trees are containerized, the rootballs shall be shaved at the periphery and radial slices made to correct all circling roots and rootball deficiencies.
- All newly planted trees shall be properly guyed and staked at the time of planting to ensure establishment and erect growth, in accordance with the specification as set forth in the Administrative Manual. Trees shall be restaked in the event of blow overs or the failure of the staking and guying. A tree shall remain braced for at least one year after its planting.
- In areas where paved surfaces abut sod or mulch, the final level of both surfaces should be even.
- All planting shall be installed with fertilizer at time of planting.
- All planting shall be installed in a sound, workmanlike manner and according to good planting procedures. Installation shall include watering, weeding, fertilizing, mulching, selective

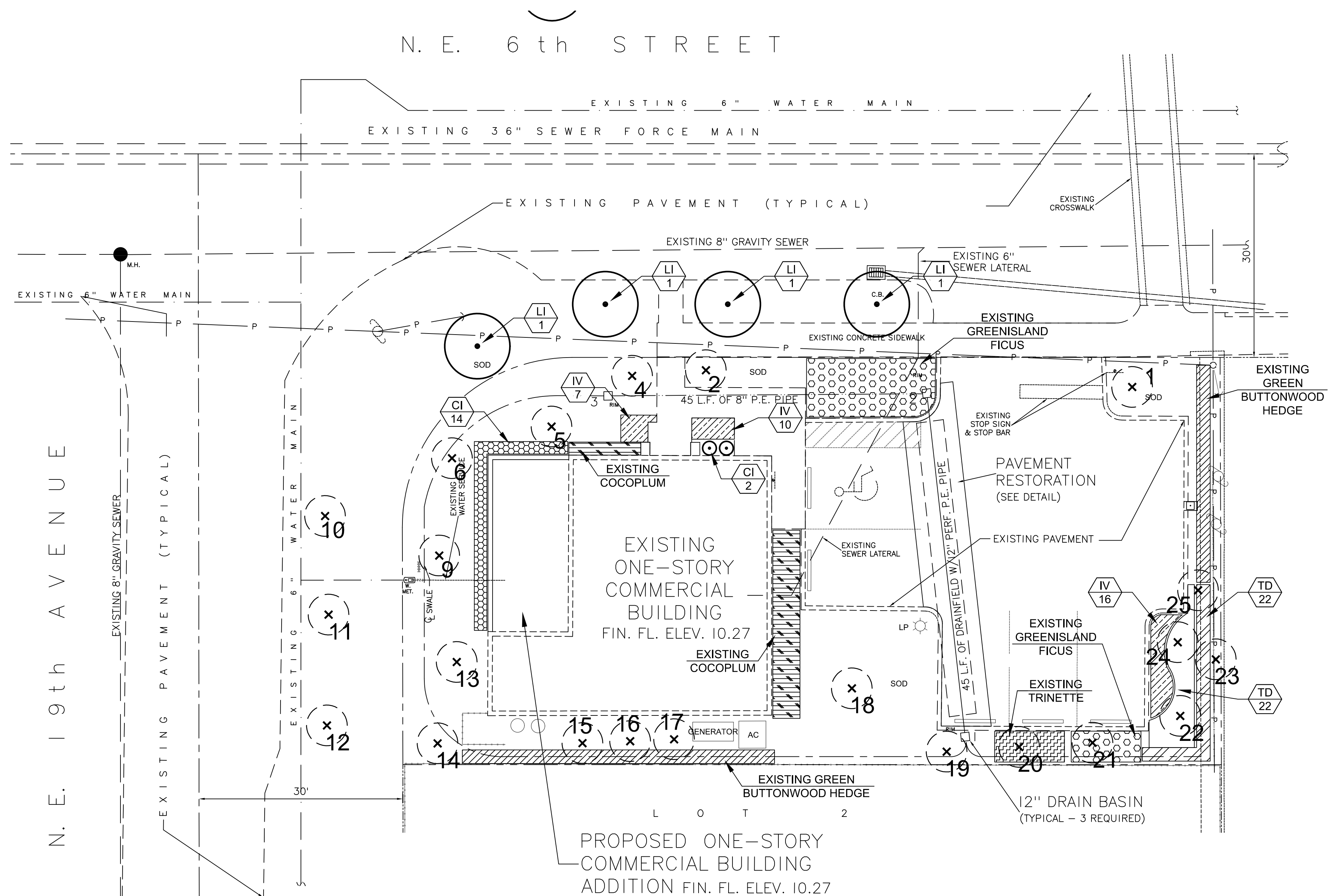

Plant List					
Sym	Qty	Botanical Name	Common Name	Size	Native Drought Tolerance
Trees/Palms					
LI	4	Lagerstroemia indica 'Muskogee'	Crape Myrtle	12' Ht. x 4' Spr., 2" cal., single trunk	No High
Shrubs/Groundcovers					
CI	16	Chrysobalanus icaco	Cocoplum	24" x 24", 24" O.C.	Yes Medium
IV	33	Ilex vomitoria 'Stokes Dwarf'	Dwarf Ilex	10" x 10", 18" O.C.	Yes High
TD	22	Tripsacum dactyloides	Fakahatchee Grass	24" x 24", 24" O.C.	Yes High
PL	26	Psychotria ligustrifolia	Dwarf Wild Coffee	24" x 24", 24" O.C.	Yes High
Sod			St. Augustine		
Mulch			Shredded Melaleuca or Eucalyptus		

NOTE: ALL STAKING & GUYS SHALL BE REMOVED APPROXIMATELY 9 MONTHS AFTER PLANTING OR AS DIRECTED BY LANDSCAPE ARCHITECT

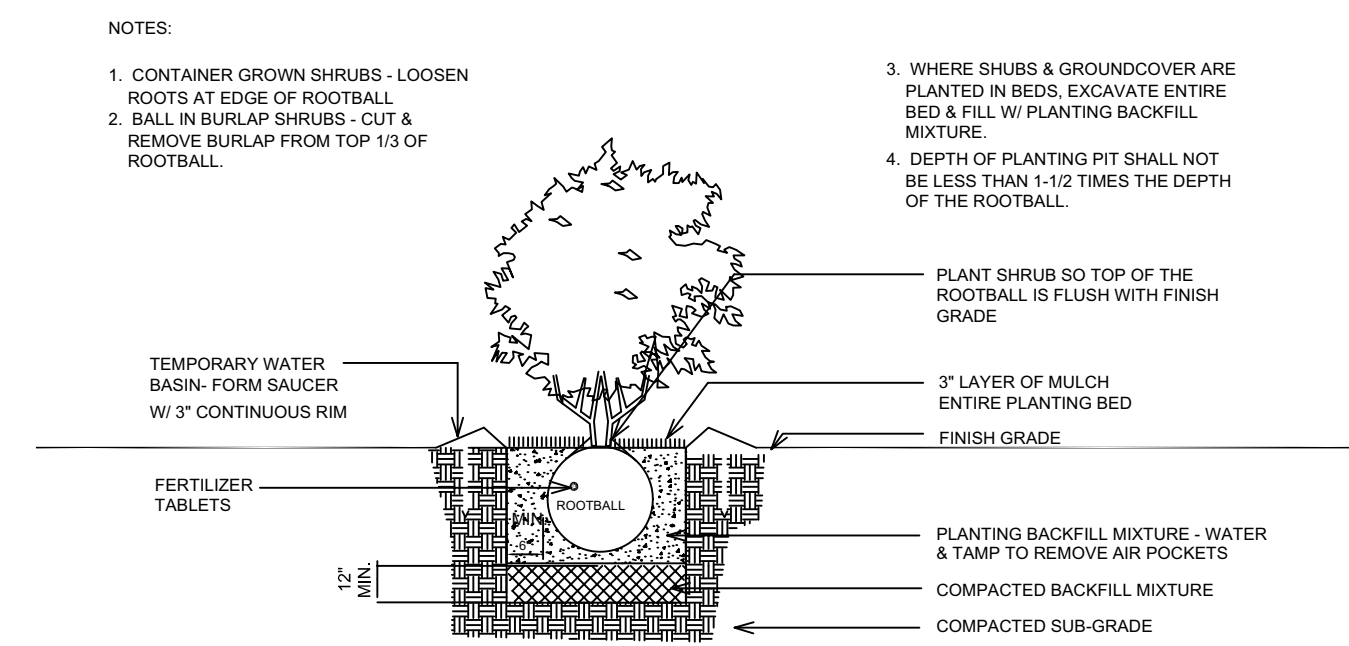

SHRUB PLANTING DETAIL

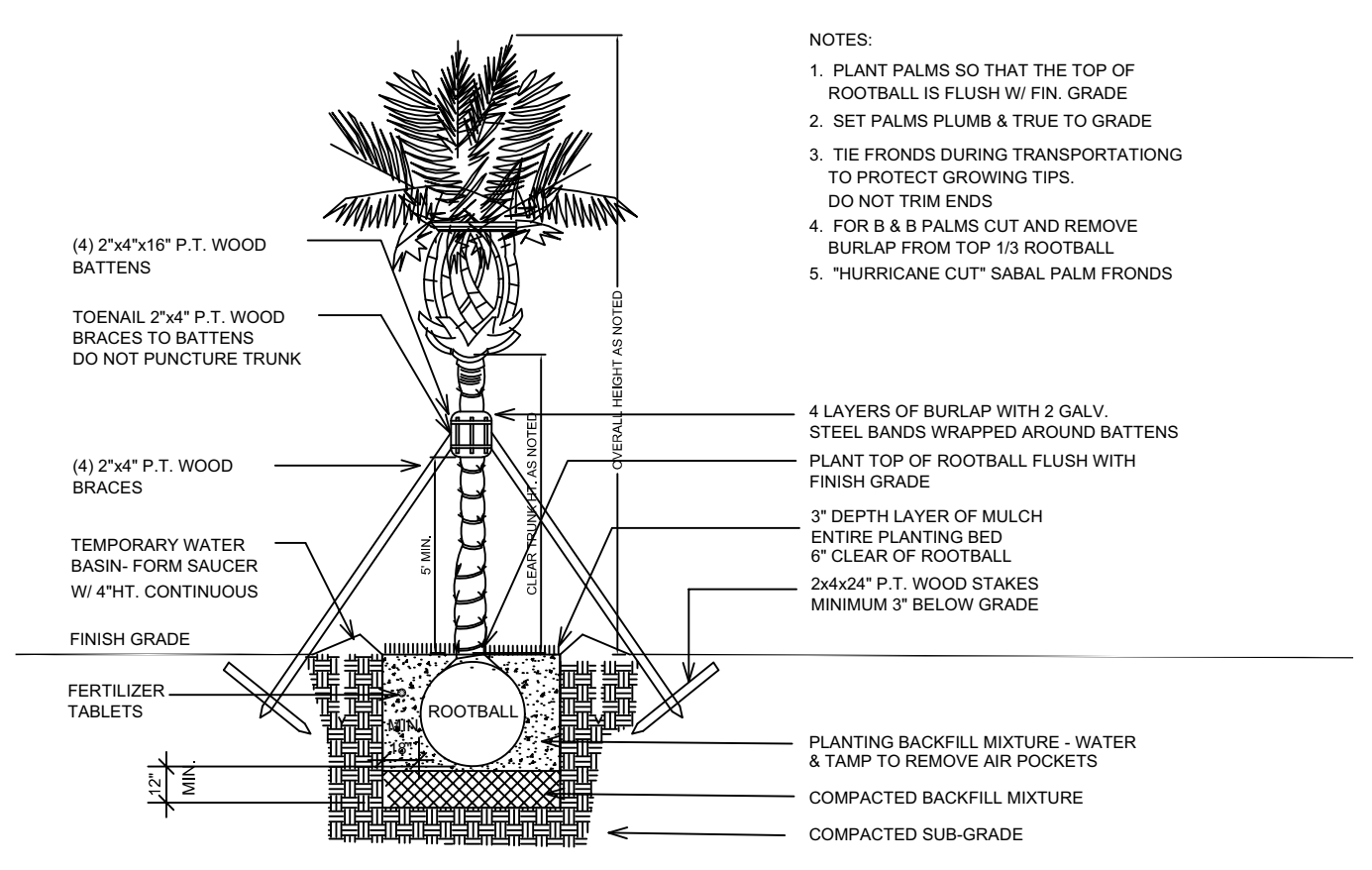

PALM PLANTING DETAIL

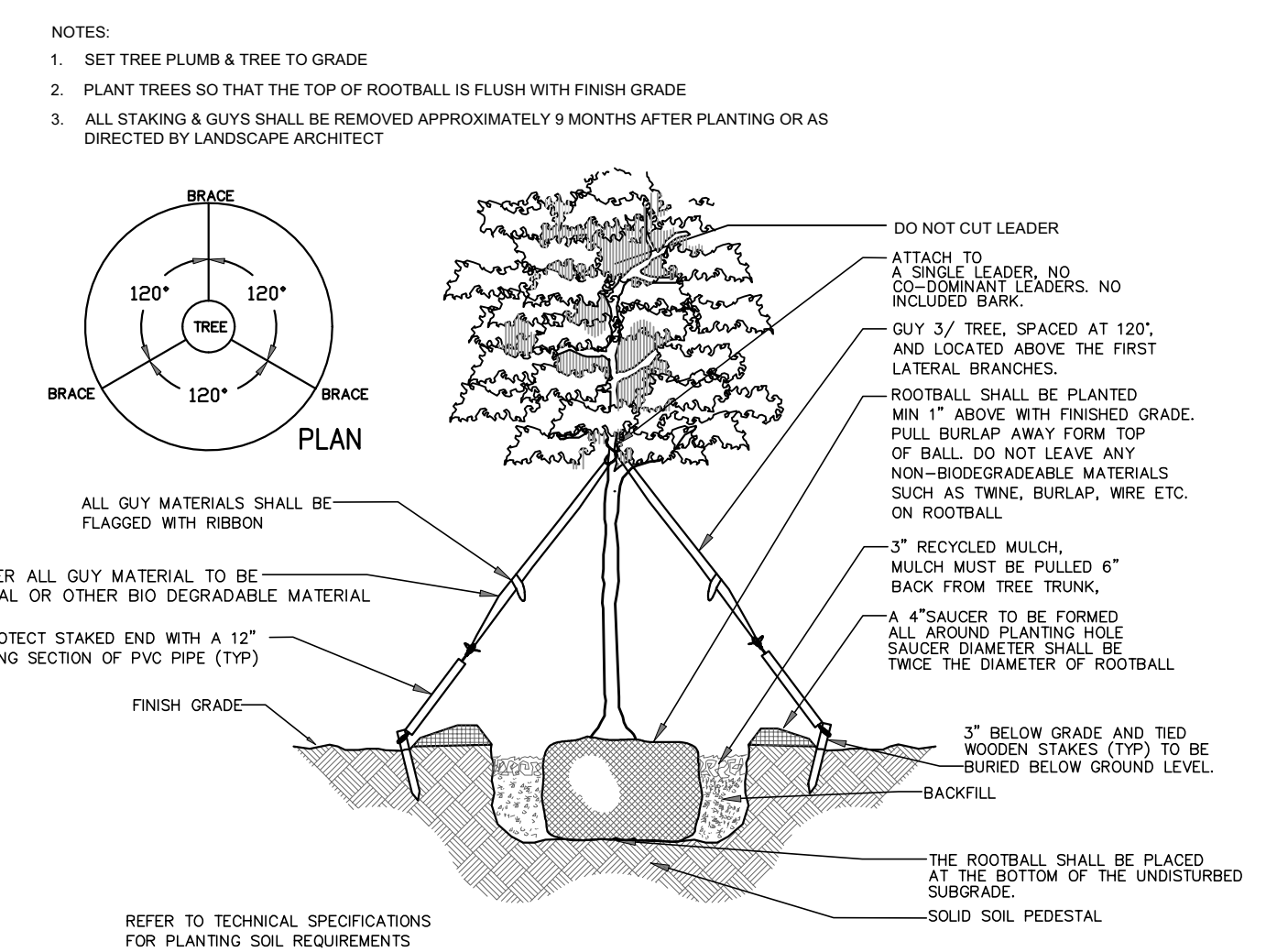

TREE STAKING DETAIL

LANDSCAPE PLAN

SCALE: 1" = 10'

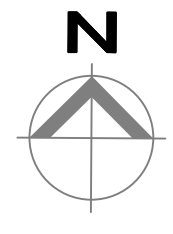
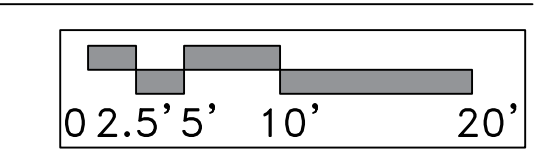

PREPARED BY:  
Kimberly Moyer, RLA  
Landscape Architecture  
(954) 592-3695  
k.moyerla@gmail.com  
Lic. No. #LA0000952

Kimberly Moyer  
Digitally signed by Kimberly Moyer  
Date: 2023.08.15 10:50:33 -04'00'

POMPANO BEACH  
CREDIT UNION

420 NE 19 AVENUE  
POMPANO BEACH, FL 33060

DATE: AUGUST 15, 2023  
PROJECT NUMBER:  
DRAWN BY: PW  
CHECKED BY: K.M.  
SCALE: 1"=10'-00"  
REVISION: DATE: BY:

SHEET NUMBER:  
L-1